

# Hinge Adjustments

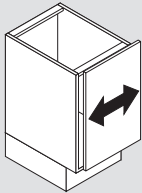

## CLIP top Hinge Adjustments

### Side adjustment



Turn front screw clockwise to increase door overlay, counter-clockwise to decrease.  
**Range = 4 (5/32")**

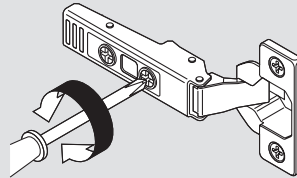

### Depth adjustment

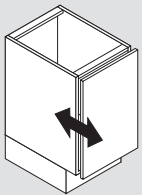

Rotate back screw to adjust door position.  
**Range = 5 (3/16")**

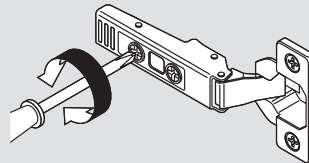

### Height adjustment

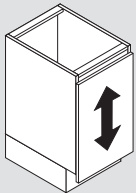

Rotate cam screw to adjust door height up or down. **Range = 4 (5/32")**

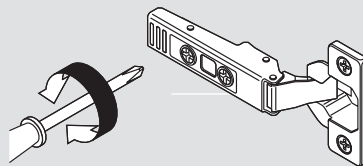

### Door removal and installation

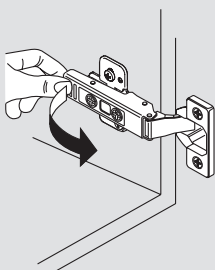

Release the lever under the hinge arm to remove.

To install, place the hinge on the mounting plate and push the back of the hinge arm down with finger pressure. The "click" sound confirms a secure attachment.

